

72-55TMC EN MORTISE LOCK

1. FUNCTION:

When the door close, the lock becomes locked automatically. The dead bolt throws out and the latch bolt is blocked.

When the controlled handle or panic handle is down, the dead bolt is withdraw inside the lock case and the latch bolt is release consequently.

Mechanical opening using key cylinder is always possible from both sides and the lock can be opened by inside handle (anti-panic feature)



2. TECHNICAL DETAILS

- Operating voltage: 3.3-6V DC
- Current: Max. 120ma.
- Micro switches: Max. 125V, 1A
- Operating temperature:
-20°C - +60°C
- Monitoring outputs: Deadbolt
- Bolt throw: 20 mm (deadbolt),
- 10 mm (double action bolt)
- Backset: 55mm
- Distance: 72mm
- Forend: 20, 24 mm
- Spindle: 8x8mm
- None handed

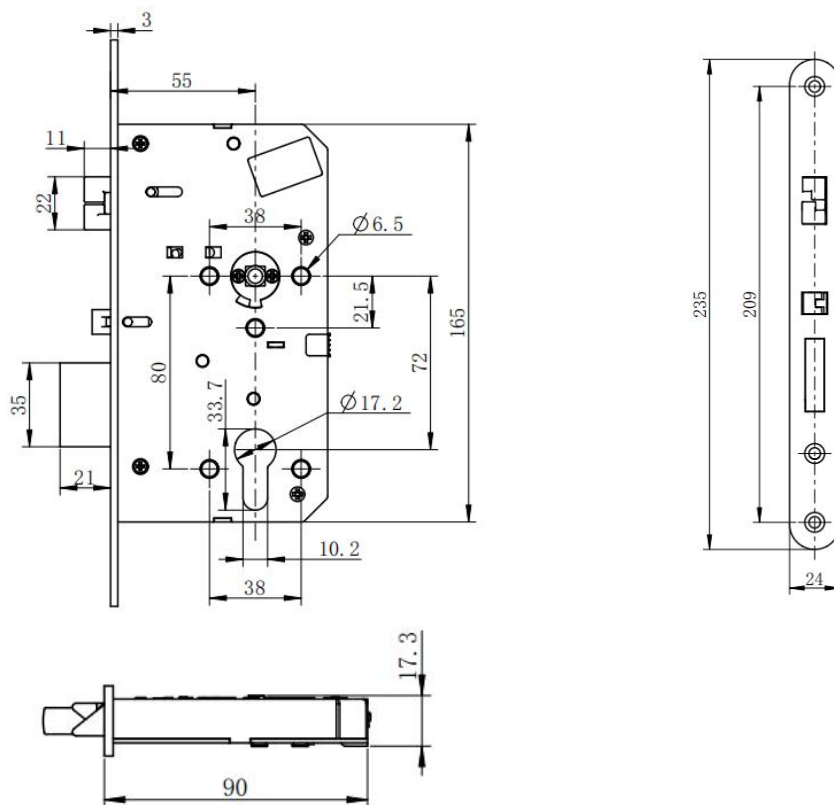

3. HANDED SETTING

The 2 handed screws forward interior.

If the delivery standard doesn't meet the handed requirement, change the 2 screws to other side.

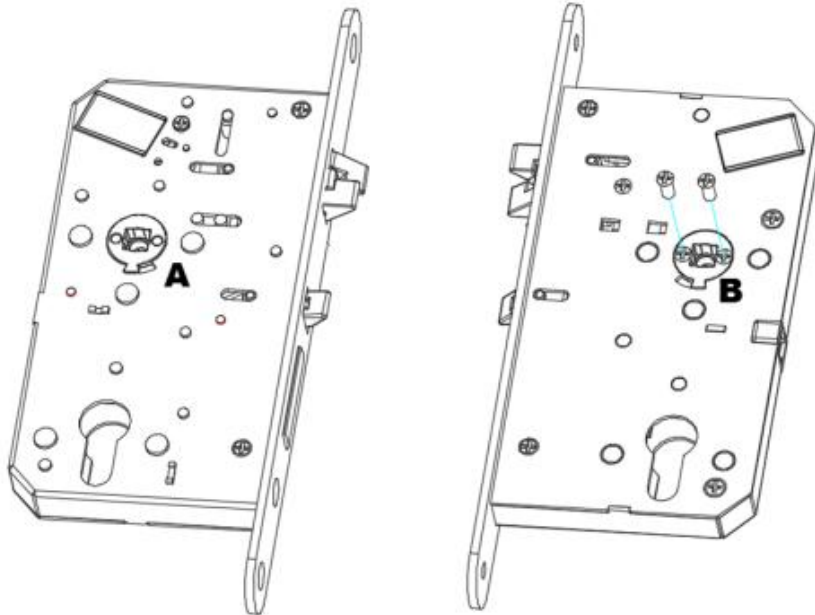

4. WIRING DIAGRAM

